



Stativsystem Type STAT / SSTAT

Stativsystem i el-galvaniseret materiale. For indendørs montage

STAT : rør 35x35x2,0
fittings 40x40x2,0

Stativsystem i galvaniseret materiale. For undendørs montage

SSTAT : rør 45x45x2,0
fittings 50x50x2,0

Rør L=3000
type STAT-1
og SSTAT-U-1

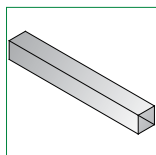

Hjørne
type STAT-2
og SSTAT-U-2

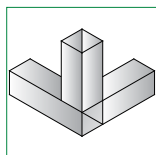

T-rør
type STAT-3
og SSTAT-U-3

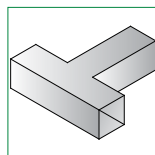

Fod
type STAT-4
og SSTAT-U-4

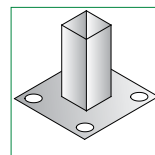

Vægbeslag
type STAT-5
og SSTAT-U-5

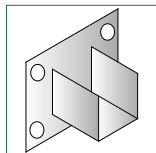

Vinkel 45°
type STAT-6
og SSTAT-U-6

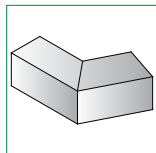

Vinkel 90°
type STAT-7
og SSTAT-U-7

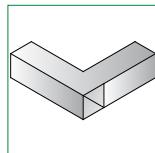

Plastprop
type STAT-8
og SSTAT-U-8

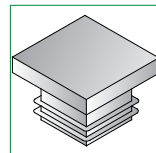

Kryds
type STAT-9
og SSTAT-U-9

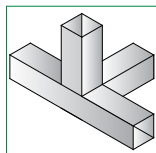

Justerbar fod
type STAT-10

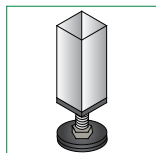

Montagekomponenter

Type OS

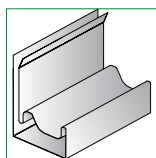

Flangeprofil

Type C

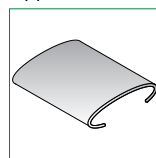

Samleskinne for OS20

Type OT

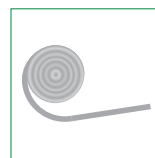

Tætningsliste

Type OH

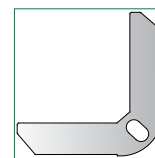

Indvendig hjørne
for OS

Type OK

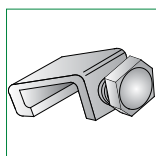

Klemskrue

Type BFS

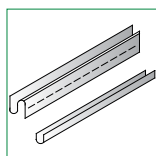

Skinne

Type UH

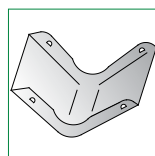

Udvendig hjørne for
OS-20